



**PRENSA CABOS A2F EM
AÇO INOX, LATÃO E ALUMÍNIO**



PRENSA CABOS A2F EM AÇO INOX, LATÃO E ALUMÍNIO

Pressa Cabo A2F para cabos não armados à Prova de Explosão Ex d, Ex e, Ex t



Cabos Não armados

Classificação: Ex db / Ex eb / Ex ta

Materiais: Alumínio Copper-free, Latão Naval Puro, Latão Naval Niquelado e Aço Inox 304L e 316L

Roscas: NPT e BSP 1/2", 3/4", 1", 1 1/4", 1 1/2", 2", 2 1/2" e 3"

Métricos: M16, M20, M25, M32, M40, M50, M63 e M75

Recebem as marcações:

II 2 G Ex db IIC Gb Ex eb IIC Gb

II 1 D Ex ta IIIC Da

Podendo ser aplicados para as seguintes condições de uso:

Ex db, Ex dc, Ex eb, Ex ec, Ex ia, Ex ib, Ex ic, Ex ma, Ex mb, Ex mc, Ex nA, Ex nR, Ex nC, Ex o, Ex pz, Ex px, Ex py, Ex q, Ex ta, Ex tb, Ex tc



Vantagens

■ Temperatura de trabalho

 -20°C até +90°C

com uso de borrachas de NBR e VITON

 -40°C até +100°C

com uso de borrachas de SILICONE

 -40°C até +200°C

Consulte as certificações disponíveis para essa faixa de temperatura

■ Certificação conformidade



■ Grau de proteção para Latão, Latão Niquelado e Alumínio
IP66/IP67/IP68 até 50m por 30 minutos

■ Grau de proteção (Nevoa salina) para aço Inox 304L e 316L
IP66W/IP67W/IP68W até 50m por 30 minutos

 Proteção contra gases e poeira explosiva

Aplicações

■  Indústria petroquímica  Offshore  Indústria Naval



PRENSA CABOS

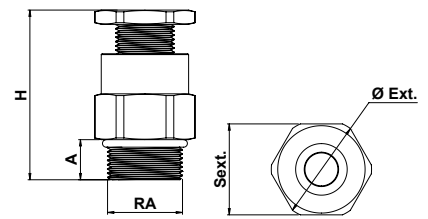

PRENSA CABO A2F | ROSCA NPT

ROSCA (RA)	A	RANGE	SEXT (mm)	Ø EXT (mm)	H (mm)	VEDAÇÃO	CÓDIGOS				
							ALUMÍNIO	LATÃO	LATÃO NIQUELADO	AÇO INOX 304L	AÇO INOX 316L
1/2"	14	3 - 8,5mm	1" (25,40mm)	28	54	NITRÍLICA	A2FN012A/3-8.5/NBR	A2FN012L/3-8.5/NBR	A2FN012LN/3-8.5/NBR	A2FN012304L/3-8.5/NBR	A2FN012316L/3-8.5/NBR
							SILICONE	A2FN012A/3-8.5/SIL	A2FN012L/3-8.5/SIL	A2FN012LN/3-8.5/SIL	A2FN012304L/3-8.5/SIL
		8 - 11,5mm	1" (25,40mm)	28	54	NITRÍLICA	A2FN012A/8-11.5/NBR	A2FN012L/8-11.5/NBR	A2FN012LN/8-11.5/NBR	A2FN012304L/8-11.5/NBR	A2FN012316L/8-11.5/NBR
							SILICONE	A2FN012A/8-11.5/SIL	A2FN012L/8-11.5/SIL	A2FN012LN/8-11.5/SIL	A2FN012304L/8-11.5/SIL
		11 - 13,5mm	1" (25,40mm)	28	54	NITRÍLICA	A2FN012A/11-13.5/NBR	A2FN012L/11-13.5/NBR	A2FN012LN/11-13.5/NBR	A2FN012304L/11-13.5/NBR	A2FN012316L/11-13.5/NBR
							SILICONE	A2FN012A/11-13.5/SIL	A2FN012L/11-13.5/SIL	A2FN012LN/11-13.5/SIL	A2FN012304L/11-13.5/SIL
10 - 15mm	1.1/4" (31,75mm)	35	58	NITRÍLICA	A2FN012A/10-15/NBR	A2FN012L/10-15/NBR	A2FN012LN/10-15/NBR	A2FN012304L/10-15/NBR	A2FN012316L/10-15/NBR		
					SILICONE	A2FN012A/10-15/SIL	A2FN012L/10-15/SIL	A2FN012LN/10-15/SIL	A2FN012304L/10-15/SIL	A2FN012316L/10-15/SIL	
3/4"	14	3 - 8,5mm	1.1/4" (31,75mm)	35	54	NITRÍLICA	A2FN034A/3-8.5/NBR	A2FN034L/3-8.5/NBR	A2FN034LN/3-8.5/NBR	A2FN034304L/3-8.5/NBR	A2FN034316L/3-8.5/NBR
							SILICONE	A2FN034A/3-8.5/SIL	A2FN034L/3-8.5/SIL	A2FN034LN/3-8.5/SIL	A2FN034304L/3-8.5/SIL
		8 - 11,5mm	1.1/4" (31,75mm)	35	54	NITRÍLICA	A2FN034A/8-11.5/NBR	A2FN034L/8-11.5/NBR	A2FN034LN/8-11.5/NBR	A2FN034304L/8-11.5/NBR	A2FN034316L/8-11.5/NBR
							SILICONE	A2FN034A/8-11.5/SIL	A2FN034L/8-11.5/SIL	A2FN034LN/8-11.5/SIL	A2FN034304L/8-11.5/SIL
		10 - 15mm	1.1/4" (31,75mm)	35	54	NITRÍLICA	A2FN034A/10-15/NBR	A2FN034L/10-15/NBR	A2FN034LN/10-15/NBR	A2FN034304L/10-15/NBR	A2FN034316L/10-15/NBR
							SILICONE	A2FN034A/10-15/SIL	A2FN034L/10-15/SIL	A2FN034LN/10-15/SIL	A2FN034304L/10-15/SIL
8 - 13,5mm	1.1/2" (38,10mm)	42	61	NITRÍLICA	A2FN034A/8-13.5/NBR	A2FN034L/8-13.5/NBR	A2FN034LN/8-13.5/NBR	A2FN034304L/8-13.5/NBR	A2FN034316L/8-13.5/NBR		
					SILICONE	A2FN034A/8-13.5/SIL	A2FN034L/8-13.5/SIL	A2FN034LN/8-13.5/SIL	A2FN034304L/8-13.5/SIL	A2FN034316L/8-13.5/SIL	
13 - 19,5mm	1.1/2" (38,10mm)	42	61	NITRÍLICA	A2FN034A/13-19.5/NBR	A2FN034L/13-19.5/NBR	A2FN034LN/13-19.5/NBR	A2FN034304L/13-19.5/NBR	A2FN034316L/13-19.5/NBR		
					SILICONE	A2FN034A/13-19.5/SIL	A2FN034L/13-19.5/SIL	A2FN034LN/13-19.5/SIL	A2FN034304L/13-19.5/SIL	A2FN034316L/13-19.5/SIL	
1"	17	8 - 13,5mm	1.1/2" (38,10mm)	42	59	NITRÍLICA	A2FN001A/8-13.5/NBR	A2FN001L/8-13.5/NBR	A2FN001LN/8-13.5/NBR	A2FN001304L/8-13.5/NBR	A2FN001316L/8-13.5/NBR
							SILICONE	A2FN001A/8-13.5/SIL	A2FN001L/8-13.5/SIL	A2FN001LN/8-13.5/SIL	A2FN001304L/8-13.5/SIL
		13 - 19,5mm	1.1/2" (38,10mm)	42	59	NITRÍLICA	A2FN001A/13-19.5/NBR	A2FN001L/13-19.5/NBR	A2FN001LN/13-19.5/NBR	A2FN001304L/13-19.5/NBR	A2FN001316L/13-19.5/NBR
							SILICONE	A2FN001A/13-19.5/SIL	A2FN001L/13-19.5/SIL	A2FN001LN/13-19.5/SIL	A2FN001304L/13-19.5/SIL
		14 - 20mm	1.3/4" (44,45mm)	50	68	NITRÍLICA	A2FN001A/14-20/NBR	A2FN001L/14-20/NBR	A2FN001LN/14-20/NBR	A2FN001304L/14-20/NBR	A2FN001316L/14-20/NBR
							SILICONE	A2FN001A/14-20/SIL	A2FN001L/14-20/SIL	A2FN001LN/14-20/SIL	A2FN001304L/14-20/SIL
20 - 25,5mm	1.3/4" (44,45mm)	50	68	NITRÍLICA	A2FN001A/20-25.5/NBR	A2FN001L/20-25.5/NBR	A2FN001LN/20-25.5/NBR	A2FN001304L/20-25.5/NBR	A2FN001316L/20-25.5/NBR		
					SILICONE	A2FN001A/20-25.5/SIL	A2FN001L/20-25.5/SIL	A2FN001LN/20-25.5/SIL	A2FN001304L/20-25.5/SIL	A2FN001316L/20-25.5/SIL	
14 - 20mm	1.3/4" (44,45mm)	50	64	NITRÍLICA	A2FN114A/14-20/NBR	A2FN114L/14-20/NBR	A2FN114LN/14-20/NBR	A2FN114304L/14-20/NBR	A2FN114316L/14-20/NBR		
					SILICONE	A2FN114A/14-20/SIL	A2FN114L/14-20/SIL	A2FN114LN/14-20/SIL	A2FN114304L/14-20/SIL	A2FN114316L/14-20/SIL	
1.1/4"	18	20 - 25,5mm	1.3/4" (44,45mm)	50	64	NITRÍLICA	A2FN114A/20-25.5/NBR	A2FN114L/20-25.5/NBR	A2FN114LN/20-25.5/NBR	A2FN114304L/20-25.5/NBR	A2FN114316L/20-25.5/NBR
							SILICONE	A2FN114A/20-25.5/SIL	A2FN114L/20-25.5/SIL	A2FN114LN/20-25.5/SIL	A2FN114304L/20-25.5/SIL
		22 - 32mm	2.1/4" (57,15mm)	62	71	NITRÍLICA	A2FN114A/22-32/NBR	A2FN114L/22-32/NBR	A2FN114LN/22-32/NBR	A2FN114304L/22-32/NBR	A2FN114316L/22-32/NBR
							SILICONE	A2FN114A/22-32/SIL	A2FN114L/22-32/SIL	A2FN114LN/22-32/SIL	A2FN114304L/22-32/SIL
		18 - 23mm	2.1/4" (57,15mm)	62	68	NITRÍLICA	A2FN112A/18-23/NBR	A2FN112L/18-23/NBR	A2FN112LN/18-23/NBR	A2FN112304L/18-23/NBR	A2FN112316L/18-23/NBR
							SILICONE	A2FN112A/18-23/SIL	A2FN112L/18-23/SIL	A2FN112LN/18-23/SIL	A2FN112304L/18-23/SIL
22 - 32mm	2.1/4" (57,15mm)	62	68	NITRÍLICA	A2FN112A/22-32/NBR	A2FN112L/22-32/NBR	A2FN112LN/22-32/NBR	A2FN112304L/22-32/NBR	A2FN112316L/22-32/NBR		
					SILICONE	A2FN112A/22-32/SIL	A2FN112L/22-32/SIL	A2FN112LN/22-32/SIL	A2FN112304L/22-32/SIL	A2FN112316L/22-32/SIL	
1.1/2"	18	28 - 36mm	2.3/4" (69,85mm)	75	77	NITRÍLICA	A2FN112A/28-36/NBR	A2FN112L/28-36/NBR	A2FN112LN/28-36/NBR	A2FN112304L/28-36/NBR	A2FN112316L/28-36/NBR
							SILICONE	A2FN112A/28-36/SIL	A2FN112L/28-36/SIL	A2FN112LN/28-36/SIL	A2FN112304L/28-36/SIL
		18 - 23mm	2.3/4" (69,85mm)	75	69	NITRÍLICA	A2FN002A/18-23/NBR	A2FN002L/18-23/NBR	A2FN002LN/18-23/NBR	A2FN002304L/18-23/NBR	A2FN002316L/18-23/NBR
							SILICONE	A2FN002A/18-23/SIL	A2FN002L/18-23/SIL	A2FN002LN/18-23/SIL	A2FN002304L/18-23/SIL
		22 - 32mm	2.3/4" (69,85mm)	75	69	NITRÍLICA	A2FN002A/22-32/NBR	A2FN002L/22-32/NBR	A2FN002LN/22-32/NBR	A2FN002304L/22-32/NBR	A2FN002316L/22-32/NBR
							SILICONE	A2FN002A/22-32/SIL	A2FN002L/22-32/SIL	A2FN002LN/22-32/SIL	A2FN002304L/22-32/SIL
28 - 36mm	2.3/4" (69,85mm)	75	71	NITRÍLICA	A2FN002A/28-36/NBR	A2FN002L/28-36/NBR	A2FN002LN/28-36/NBR	A2FN002304L/28-36/NBR	A2FN002316L/28-36/NBR		
					SILICONE	A2FN002A/28-36/SIL	A2FN002L/28-36/SIL	A2FN002LN/28-36/SIL	A2FN002304L/28-36/SIL	A2FN002316L/28-36/SIL	
2"	19	36 - 43mm	2.3/4" (69,85mm)	75	71	NITRÍLICA	A2FN002A/36-43/NBR	A2FN002L/36-43/NBR	A2FN002LN/36-43/NBR	A2FN002304L/36-43/NBR	A2FN002316L/36-43/NBR
							SILICONE	A2FN002A/36-43/SIL	A2FN002L/36-43/SIL	A2FN002LN/36-43/SIL	A2FN002304L/36-43/SIL
		28 - 36mm	3.1/4" (82,55mm)	88	83	NITRÍLICA	A2FN212A/28-36/NBR	A2FN212L/28-36/NBR	A2FN212LN/28-36/NBR	A2FN212304L/28-36/NBR	A2FN212316L/28-36/NBR
							SILICONE	A2FN212A/28-36/SIL	A2FN212L/28-36/SIL	A2FN212LN/28-36/SIL	A2FN212304L/28-36/SIL
		36 - 43mm	3.1/4" (82,55mm)	88	83	NITRÍLICA	A2FN212A/36-43/NBR	A2FN212L/36-43/NBR	A2FN212LN/36-43/NBR	A2FN212304L/36-43/NBR	A2FN212316L/36-43/NBR
							SILICONE	A2FN212A/36-43/SIL	A2FN212L/36-43/SIL	A2FN212LN/36-43/SIL	A2FN212304L/36-43/SIL
36,5 - 45mm	3.1/4" (82,55mm)	88	83	NITRÍLICA	A2FN212A/36.5-45/NBR	A2FN212L/36.5-45/NBR	A2FN212LN/36.5-45/NBR	A2FN212304L/36.5-45/NBR	A2FN212316L/36.5-45/NBR		
					SILICONE	A2FN212A/36.5-45/SIL	A2FN212L/36.5-45/SIL	A2FN212LN/36.5-45/SIL	A2FN212304L/36.5-45/SIL	A2FN212316L/36.5-45/SIL	
45 - 55mm	3.1/4" (82,55mm)	88	83	NITRÍLICA	A2FN212A/45-55/NBR	A2FN212L/45-55/NBR	A2FN212LN/45-55/NBR	A2FN212304L/45-55/NBR	A2FN212316L/45-55/NBR		
					SILICONE	A2FN212A/45-55/SIL	A2FN212L/45-55/SIL	A2FN212LN/45-55/SIL	A2FN212304L/45-55/SIL	A2FN212316L/45-55/SIL	
2.1/2"	29	36,5 - 45mm	4" (101,60mm)	110	90	NITRÍLICA	A2FN003A/36.5-45/NBR	A2FN003L/36.5-45/NBR	A2FN003LN/36.5-45/NBR	A2FN003304L/36.5-45/NBR	A2FN003316L/36.5-45/NBR
							SILICONE	A2FN003A/36.5-45/SIL	A2FN003L/36.5-45/SIL	A2FN003LN/36.5-45/SIL	A2FN003304L/36.5-45/SIL
		41 - 55,5mm	4" (101,60mm)	110	90	NITRÍLICA	A2FN003A/41-55.5/NBR	A2FN003L/41-55.5/NBR	A2FN003LN/41-55.5/NBR	A2FN003304L/41-55.5/NBR	A2FN003316L/41-55.5/NBR
							SILICONE	A2FN003A/41-55.5/SIL	A2FN003L/41-55.5/SIL	A2FN003LN/41-55.5/SIL	A2FN003304L/41-55.5/SIL
		54,5 - 67mm	4" (101,60mm)	110	90	NITRÍLICA	A2FN003A/54.5-67/NBR	A2FN003L/54.5-67/NBR	A2FN003LN/54.5-67/NBR	A2FN003304L/54.5-67/NBR	A2FN003316L/54.5-67/NBR
							SILICONE	A2FN003A/54.5-67/SIL	A2FN003L/54.5-67/SIL	A2FN003LN/54.5-67/SIL	A2FN003304L/54.5-67/SIL

LEGENDA: H - ALTURA APROXIMADA | A - COMPRIMENTO DA ROSCA | Ø EXT - Ø EXTERNO (mm) | ☞ SEXTAVADO

PRENSA CABOS

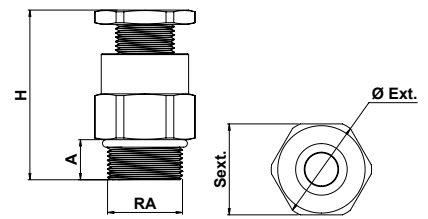

PRENSA CABO A2F | ROSCA BSP

ROSCA (RA)	A	RANGE	SEXT (mm)	Ø EXT (mm)	H (mm)	VEDAÇÃO	CÓDIGOS					
							ALUMÍNIO	LATÃO	LATÃO NIQUELADO	AÇO INOX 304L	AÇO INOX 316L	
1/2"	14	3 - 8,5mm	1" (25,40mm)	28	59	NITRILICA	A2FB012A/3-8.5/NBR	A2FB012L/3-8.5/NBR	A2FB012LN/3-8.5/NBR	A2FB012304L/3-8.5/NBR	A2FB012316L/3-8.5/NBR	
							SILICONE	A2FB012A/3-8.5/SIL	A2FB012L/3-8.5/SIL	A2FB012LN/3-8.5/SIL	A2FB012304L/3-8.5/SIL	A2FB012316L/3-8.5/SIL
		8 - 11,5mm	1" (25,40mm)	28	59	NITRILICA	A2FB012A/8-11.5/NBR	A2FB012L/8-11.5/NBR	A2FB012LN/8-11.5/NBR	A2FB012304L/8-11.5/NBR	A2FB012316L/8-11.5/NBR	
							SILICONE	A2FB012A/8-11.5/SIL	A2FB012L/8-11.5/SIL	A2FB012LN/8-11.5/SIL	A2FB012304L/8-11.5/SIL	A2FB012316L/8-11.5/SIL
		11 - 13,5mm	1" (25,40mm)	28	59	NITRILICA	A2FB012A/11-13.5/NBR	A2FB012L/11-13.5/NBR	A2FB012LN/11-13.5/NBR	A2FB012304L/11-13.5/NBR	A2FB012316L/11-13.5/NBR	
							SILICONE	A2FB012A/11-13.5/SIL	A2FB012L/11-13.5/SIL	A2FB012LN/11-13.5/SIL	A2FB012304L/11-13.5/SIL	A2FB012316L/11-13.5/SIL
	10 - 15mm	1.1/4" (31,75mm)	35	59	NITRILICA	A2FB012A/10-15/NBR	A2FB012L/10-15/NBR	A2FB012LN/10-15/NBR	A2FB012304L/10-15/NBR	A2FB012316L/10-15/NBR		
						SILICONE	A2FB012A/10-15/SIL	A2FB012L/10-15/SIL	A2FB012LN/10-15/SIL	A2FB012304L/10-15/SIL	A2FB012316L/10-15/SIL	
	3/4"	14	3 - 8,5mm	1.1/4" (31,75mm)	35	59	NITRILICA	A2FB034A/3-8.5/NBR	A2FB034L/3-8.5/NBR	A2FB034LN/3-8.5/NBR	A2FB034304L/3-8.5/NBR	A2FB034316L/3-8.5/NBR
								SILICONE	A2FB034A/3-8.5/SIL	A2FB034L/3-8.5/SIL	A2FB034LN/3-8.5/SIL	A2FB034304L/3-8.5/SIL
			8 - 11,5mm	1.1/4" (31,75mm)	35	59	NITRILICA	A2FB034A/8-11.5/NBR	A2FB034L/8-11.5/NBR	A2FB034LN/8-11.5/NBR	A2FB034304L/8-11.5/NBR	A2FB034316L/8-11.5/NBR
								SILICONE	A2FB034A/8-11.5/SIL	A2FB034L/8-11.5/SIL	A2FB034LN/8-11.5/SIL	A2FB034304L/8-11.5/SIL
10 - 15mm			1.1/4" (31,75mm)	35	59	NITRILICA	A2FB034A/10-15/NBR	A2FB034L/10-15/NBR	A2FB034LN/10-15/NBR	A2FB034304L/10-15/NBR	A2FB034316L/10-15/NBR	
							SILICONE	A2FB034A/10-15/SIL	A2FB034L/10-15/SIL	A2FB034LN/10-15/SIL	A2FB034304L/10-15/SIL	A2FB034316L/10-15/SIL
8 - 13,5mm		1.1/2" (38,10mm)	42	61	NITRILICA	A2FB034A/8-13.5/NBR	A2FB034L/8-13.5/NBR	A2FB034LN/8-13.5/NBR	A2FB034304L/8-13.5/NBR	A2FB034316L/8-13.5/NBR		
						SILICONE	A2FB034A/8-13.5/SIL	A2FB034L/8-13.5/SIL	A2FB034LN/8-13.5/SIL	A2FB034304L/8-13.5/SIL	A2FB034316L/8-13.5/SIL	
13 - 19,5mm		1.1/2" (38,10mm)	42	61	NITRILICA	A2FB034A/13-19.5/NBR	A2FB034L/13-19.5/NBR	A2FB034LN/13-19.5/NBR	A2FB034304L/13-19.5/NBR	A2FB034316L/13-19.5/NBR		
						SILICONE	A2FB034A/13-19.5/SIL	A2FB034L/13-19.5/SIL	A2FB034LN/13-19.5/SIL	A2FB034304L/13-19.5/SIL	A2FB034316L/13-19.5/SIL	
8 - 13,5mm		1.1/2" (38,10mm)	42	61	NITRILICA	A2FB001A/8-13.5/NBR	A2FB001L/8-13.5/NBR	A2FB001LN/8-13.5/NBR	A2FB001304L/8-13.5/NBR	A2FB001316L/8-13.5/NBR		
						SILICONE	A2FB001A/8-13.5/SIL	A2FB001L/8-13.5/SIL	A2FB001LN/8-13.5/SIL	A2FB001304L/8-13.5/SIL	A2FB001316L/8-13.5/SIL	
13 - 19,5mm	1.1/2" (38,10mm)	42	61	NITRILICA	A2FB001A/13-19.5/NBR	A2FB001L/13-19.5/NBR	A2FB001LN/13-19.5/NBR	A2FB001304L/13-19.5/NBR	A2FB001316L/13-19.5/NBR			
					SILICONE	A2FB001A/13-19.5/SIL	A2FB001L/13-19.5/SIL	A2FB001LN/13-19.5/SIL	A2FB001304L/13-19.5/SIL	A2FB001316L/13-19.5/SIL		
14 - 20mm	1.3/4" (44,45mm)	50	68	NITRILICA	A2FB001A/14-20/NBR	A2FB001L/14-20/NBR	A2FB001LN/14-20/NBR	A2FB001304L/14-20/NBR	A2FB001316L/14-20/NBR			
					SILICONE	A2FB001A/14-20/SIL	A2FB001L/14-20/SIL	A2FB001LN/14-20/SIL	A2FB001304L/14-20/SIL	A2FB001316L/14-20/SIL		
20 - 25,5mm	1.3/4" (44,45mm)	50	68	NITRILICA	A2FB001A/20-25.5/NBR	A2FB001L/20-25.5/NBR	A2FB001LN/20-25.5/NBR	A2FB001304L/20-25.5/NBR	A2FB001316L/20-25.5/NBR			
					SILICONE	A2FB001A/20-25.5/SIL	A2FB001L/20-25.5/SIL	A2FB001LN/20-25.5/SIL	A2FB001304L/20-25.5/SIL	A2FB001316L/20-25.5/SIL		
1.1/4"	18	14 - 20mm	1.3/4" (44,45mm)	50	66	NITRILICA	A2FB114A/14-20/NBR	A2FB114L/14-20/NBR	A2FB114LN/14-20/NBR	A2FB114304L/14-20/NBR	A2FB114316L/14-20/NBR	
							SILICONE	A2FB114A/14-20/SIL	A2FB114L/14-20/SIL	A2FB114LN/14-20/SIL	A2FB114304L/14-20/SIL	A2FB114316L/14-20/SIL
		20 - 25,5mm	1.3/4" (44,45mm)	50	66	NITRILICA	A2FB114A/20-25.5/NBR	A2FB114L/20-25.5/NBR	A2FB114LN/20-25.5/NBR	A2FB114304L/20-25.5/NBR	A2FB114316L/20-25.5/NBR	
							SILICONE	A2FB114A/20-25.5/SIL	A2FB114L/20-25.5/SIL	A2FB114LN/20-25.5/SIL	A2FB114304L/20-25.5/SIL	A2FB114316L/20-25.5/SIL
		22 - 32mm	2.1/4" (57,15mm)	62	71	NITRILICA	A2FB114A/22-32/NBR	A2FB114L/22-32/NBR	A2FB114LN/22-32/NBR	A2FB114304L/22-32/NBR	A2FB114316L/22-32/NBR	
							SILICONE	A2FB114A/22-32/SIL	A2FB114L/22-32/SIL	A2FB114LN/22-32/SIL	A2FB114304L/22-32/SIL	A2FB114316L/22-32/SIL
	18 - 23mm	2.1/4" (57,15mm)	62	70	NITRILICA	A2FB112A/18-23/NBR	A2FB112L/18-23/NBR	A2FB112LN/18-23/NBR	A2FB112304L/18-23/NBR	A2FB112316L/18-23/NBR		
						SILICONE	A2FB112A/18-23/SIL	A2FB112L/18-23/SIL	A2FB112LN/18-23/SIL	A2FB112304L/18-23/SIL	A2FB112316L/18-23/SIL	
	22 - 32mm	2.1/4" (57,15mm)	62	70	NITRILICA	A2FB112A/22-32/NBR	A2FB112L/22-32/NBR	A2FB112LN/22-32/NBR	A2FB112304L/22-32/NBR	A2FB112316L/22-32/NBR		
						SILICONE	A2FB112A/22-32/SIL	A2FB112L/22-32/SIL	A2FB112LN/22-32/SIL	A2FB112304L/22-32/SIL	A2FB112316L/22-32/SIL	
	1.1/2"	18	28 - 36mm	2.3/4" (69,85mm)	75	77	NITRILICA	A2FB112A/28-36/NBR	A2FB112L/28-36/NBR	A2FB112LN/28-36/NBR	A2FB112304L/28-36/NBR	A2FB112316L/28-36/NBR
								SILICONE	A2FB112A/28-36/SIL	A2FB112L/28-36/SIL	A2FB112LN/28-36/SIL	A2FB112304L/28-36/SIL
18 - 23mm			2.3/4" (69,85mm)	75	71	NITRILICA	A2FB002A/18-23/NBR	A2FB002L/18-23/NBR	A2FB002LN/18-23/NBR	A2FB002304L/18-23/NBR	A2FB002316L/18-23/NBR	
							SILICONE	A2FB002A/18-23/SIL	A2FB002L/18-23/SIL	A2FB002LN/18-23/SIL	A2FB002304L/18-23/SIL	A2FB002316L/18-23/SIL
22 - 32mm			2.3/4" (69,85mm)	75	71	NITRILICA	A2FB002A/22-32/NBR	A2FB002L/22-32/NBR	A2FB002LN/22-32/NBR	A2FB002304L/22-32/NBR	A2FB002316L/22-32/NBR	
							SILICONE	A2FB002A/22-32/SIL	A2FB002L/22-32/SIL	A2FB002LN/22-32/SIL	A2FB002304L/22-32/SIL	A2FB002316L/22-32/SIL
28 - 36mm		2.3/4" (69,85mm)	75	73	NITRILICA	A2FB002A/28-36/NBR	A2FB002L/28-36/NBR	A2FB002LN/28-36/NBR	A2FB002304L/28-36/NBR	A2FB002316L/28-36/NBR		
						SILICONE	A2FB002A/28-36/SIL	A2FB002L/28-36/SIL	A2FB002LN/28-36/SIL	A2FB002304L/28-36/SIL	A2FB002316L/28-36/SIL	
36 - 43mm		2.3/4" (69,85mm)	75	73	NITRILICA	A2FB002A/36-43/NBR	A2FB002L/36-43/NBR	A2FB002LN/36-43/NBR	A2FB002304L/36-43/NBR	A2FB002316L/36-43/NBR		
						SILICONE	A2FB002A/36-43/SIL	A2FB002L/36-43/SIL	A2FB002LN/36-43/SIL	A2FB002304L/36-43/SIL	A2FB002316L/36-43/SIL	
2"		19	28 - 36mm	3.1/4" (82,55mm)	88	83	NITRILICA	A2FB212A/28-36/NBR	A2FB212L/28-36/NBR	A2FB212LN/28-36/NBR	A2FB212304L/28-36/NBR	A2FB212316L/28-36/NBR
								SILICONE	A2FB212A/28-36/SIL	A2FB212L/28-36/SIL	A2FB212LN/28-36/SIL	A2FB212304L/28-36/SIL
	36 - 43mm		3.1/4" (82,55mm)	88	83	NITRILICA	A2FB212A/36-43/NBR	A2FB212L/36-43/NBR	A2FB212LN/36-43/NBR	A2FB212304L/36-43/NBR	A2FB212316L/36-43/NBR	
							SILICONE	A2FB212A/36-43/SIL	A2FB212L/36-43/SIL	A2FB212LN/36-43/SIL	A2FB212304L/36-43/SIL	A2FB212316L/36-43/SIL
	36,5 - 45mm		3.1/4" (82,55mm)	88	83	NITRILICA	A2FB212A/36.5-45/NBR	A2FB212L/36.5-45/NBR	A2FB212LN/36.5-45/NBR	A2FB212304L/36.5-45/NBR	A2FB212316L/36.5-45/NBR	
							SILICONE	A2FB212A/36.5-45/SIL	A2FB212L/36.5-45/SIL	A2FB212LN/36.5-45/SIL	A2FB212304L/36.5-45/SIL	A2FB212316L/36.5-45/SIL
	45 - 55mm	3.1/4" (82,55mm)	88	83	NITRILICA	A2FB212A/45-55/NBR	A2FB212L/45-55/NBR	A2FB212LN/45-55/NBR	A2FB212304L/45-55/NBR	A2FB212316L/45-55/NBR		
						SILICONE	A2FB212A/45-55/SIL	A2FB212L/45-55/SIL	A2FB212LN/45-55/SIL	A2FB212304L/45-55/SIL	A2FB212316L/45-55/SIL	
	2.1/2"	29	36,5 - 45mm	4" (101,60mm)	110	90	NITRILICA	A2FB003A/36.5-45/NBR	A2FB003L/36.5-45/NBR	A2FB003LN/36.5-45/NBR	A2FB003304L/36.5-45/NBR	A2FB003316L/36.5-45/NBR
								SILICONE	A2FB003A/36.5-45/SIL	A2FB003L/36.5-45/SIL	A2FB003LN/36.5-45/SIL	A2FB003304L/36.5-45/SIL
			41 - 55,5mm	4" (101,60mm)	110	90	NITRILICA	A2FB003A/41-55.5/NBR	A2FB003L/41-55.5/NBR	A2FB003LN/41-55.5/NBR	A2FB003304L/41-55.5/NBR	A2FB003316L/41-55.5/NBR
								SILICONE	A2FB003A/41-55.5/SIL	A2FB003L/41-55.5/SIL	A2FB003LN/41-55.5/SIL	A2FB003304L/41-55.5/SIL
54,5 - 67mm			4" (101,60mm)	110	90	NITRILICA	A2FB003A/54.5-67/NBR	A2FB003L/54.5-67/NBR	A2FB003LN/54.5-67/NBR	A2FB003304L/54.5-67/NBR	A2FB003316L/54.5-67/NBR	
							SILICONE	A2FB003A/54.5-67/SIL	A2FB003L/54.5-67/SIL	A2FB003LN/54.5-67/SIL	A2FB003304L/54.5-67/SIL	A2FB003316L/54.5-67/SIL

LEGENDA: H - ALTURA APROXIMADA | A - COMPRIMENTO DA ROSCA | Ø EXT - Ø EXTERNO (mm) | ☞ SEXTAVADO

PRENSA CABOS

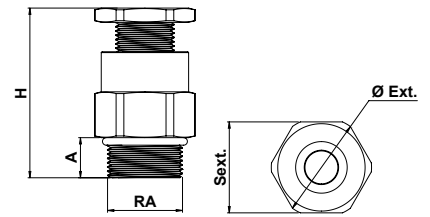

PRENSA CABO A2F | ROSCA MÉTRICA

ROSCA (RA)	A	RANGE	SEXT (mm)	Ø EXT (mm)	H (mm)	VEDAÇÃO	CÓDIGOS						
							ALUMÍNIO	LATÃO	LATÃO NIQUELADO	AÇO INOX 304L	AÇO INOX 316L		
M16x1,5	15	3 - 8,5mm	1" (25,40mm)	28	60	NITRÍLICA	A2FM16A/3-8.5/NBR	A2FM16L/3-8.5/NBR	A2FM16LN/3-8.5/NBR	A2FM16I304L/3-8.5/NBR	A2FM16I316L/3-8.5/NBR		
							SILICONE	A2FM16A/3-8.5/SIL	A2FM16L/3-8.5/SIL	A2FM16LN/3-8.5/SIL	A2FM16I304L/3-8.5/SIL	A2FM16I316L/3-8.5/SIL	
		8 - 11,5mm	1" (25,40mm)	28	60	NITRÍLICA	A2FM16A/8-11.5/NBR	A2FM16L/8-11.5/NBR	A2FM16LN/8-11.5/NBR	A2FM16I304L/8-11.5/NBR	A2FM16I316L/8-11.5/NBR		
							SILICONE	A2FM16A/8-11.5/SIL	A2FM16L/8-11.5/SIL	A2FM16LN/8-11.5/SIL	A2FM16I304L/8-11.5/SIL	A2FM16I316L/8-11.5/SIL	
		M20x1,5	15	3 - 8,5mm	1" (25,40mm)	28	60	NITRÍLICA	A2FM20A/3-8.5/NBR	A2FM20L/3-8.5/NBR	A2FM20LN/3-8.5/NBR	A2FM20I304L/3-8.5/NBR	A2FM20I316L/3-8.5/NBR
									SILICONE	A2FM20A/3-8.5/SIL	A2FM20L/3-8.5/SIL	A2FM20LN/3-8.5/SIL	A2FM20I304L/3-8.5/SIL
8 - 11,5mm	1" (25,40mm)			28	60	NITRÍLICA	A2FM20A/8-11.5/NBR	A2FM20L/8-11.5/NBR	A2FM20LN/8-11.5/NBR	A2FM20I304L/8-11.5/NBR	A2FM20I316L/8-11.5/NBR		
							SILICONE	A2FM20A/8-11.5/SIL	A2FM20L/8-11.5/SIL	A2FM20LN/8-11.5/SIL	A2FM20I304L/8-11.5/SIL	A2FM20I316L/8-11.5/SIL	
11 - 13,5mm	1" (25,40mm)			28	60	NITRÍLICA	A2FM20A/11-13.5/NBR	A2FM20L/11-13.5/NBR	A2FM20LN/11-13.5/NBR	A2FM20I304L/11-13.5/NBR	A2FM20I316L/11-13.5/NBR		
							SILICONE	A2FM20A/11-13.5/SIL	A2FM20L/11-13.5/SIL	A2FM20LN/11-13.5/SIL	A2FM20I304L/11-13.5/SIL	A2FM20I316L/11-13.5/SIL	
10 - 15mm	1.1/4" (31,75mm)	35	60	NITRÍLICA	A2FM20A/10-15/NBR	A2FM20L/10-15/NBR	A2FM20LN/10-15/NBR	A2FM20I304L/10-15/NBR	A2FM20I316L/10-15/NBR				
					SILICONE	A2FM20A/10-15/SIL	A2FM20L/10-15/SIL	A2FM20LN/10-15/SIL	A2FM20I304L/10-15/SIL	A2FM20I316L/10-15/SIL			
M25x1,5	15	3 - 8,5mm	1.1/4" (31,75mm)	35	60	NITRÍLICA	A2FM25A/3-8.5/NBR	A2FM25L/3-8.5/NBR	A2FM25LN/3-8.5/NBR	A2FM25I304L/3-8.5/NBR	A2FM25I316L/3-8.5/NBR		
							SILICONE	A2FM25A/3-8.5/SIL	A2FM25L/3-8.5/SIL	A2FM25LN/3-8.5/SIL	A2FM25I304L/3-8.5/SIL	A2FM25I316L/3-8.5/SIL	
		8 - 11,5mm	1.1/4" (31,75mm)	35	60	NITRÍLICA	A2FM25A/8-11.5/NBR	A2FM25L/8-11.5/NBR	A2FM25LN/8-11.5/NBR	A2FM25I304L/8-11.5/NBR	A2FM25I316L/8-11.5/NBR		
							SILICONE	A2FM25A/8-11.5/SIL	A2FM25L/8-11.5/SIL	A2FM25LN/8-11.5/SIL	A2FM25I304L/8-11.5/SIL	A2FM25I316L/8-11.5/SIL	
		11 - 13,5mm	1.1/4" (31,75mm)	35	60	NITRÍLICA	A2FM25A/11-13.5/NBR	A2FM25L/11-13.5/NBR	A2FM25LN/11-13.5/NBR	A2FM25I304L/11-13.5/NBR	A2FM25I316L/11-13.5/NBR		
							SILICONE	A2FM25A/11-13.5/SIL	A2FM25L/11-13.5/SIL	A2FM25LN/11-13.5/SIL	A2FM25I304L/11-13.5/SIL	A2FM25I316L/11-13.5/SIL	
10 - 15mm	1.1/4" (31,75mm)	35	60	NITRÍLICA	A2FM25A/10-15/NBR	A2FM25L/10-15/NBR	A2FM25LN/10-15/NBR	A2FM25I304L/10-15/NBR	A2FM25I316L/10-15/NBR				
					SILICONE	A2FM25A/10-15/SIL	A2FM25L/10-15/SIL	A2FM25LN/10-15/SIL	A2FM25I304L/10-15/SIL	A2FM25I316L/10-15/SIL			
M32x1,5	15	8 - 13,5mm	1.1/2" (38,10mm)	42	61	NITRÍLICA	A2FM32A/8-13.5/NBR	A2FM32L/8-13.5/NBR	A2FM32LN/8-13.5/NBR	A2FM32I304L/8-13.5/NBR	A2FM32I316L/8-13.5/NBR		
							SILICONE	A2FM32A/8-13.5/SIL	A2FM32L/8-13.5/SIL	A2FM32LN/8-13.5/SIL	A2FM32I304L/8-13.5/SIL	A2FM32I316L/8-13.5/SIL	
		13 - 19,5mm	1.1/2" (38,10mm)	42	61	NITRÍLICA	A2FM32A/13-19.5/NBR	A2FM32L/13-19.5/NBR	A2FM32LN/13-19.5/NBR	A2FM32I304L/13-19.5/NBR	A2FM32I316L/13-19.5/NBR		
							SILICONE	A2FM32A/13-19.5/SIL	A2FM32L/13-19.5/SIL	A2FM32LN/13-19.5/SIL	A2FM32I304L/13-19.5/SIL	A2FM32I316L/13-19.5/SIL	
		8 - 13,5mm	1.1/2" (38,10mm)	42	61	NITRÍLICA	A2FM32A/8-13.5/NBR	A2FM32L/8-13.5/NBR	A2FM32LN/8-13.5/NBR	A2FM32I304L/8-13.5/NBR	A2FM32I316L/8-13.5/NBR		
							SILICONE	A2FM32A/8-13.5/SIL	A2FM32L/8-13.5/SIL	A2FM32LN/8-13.5/SIL	A2FM32I304L/8-13.5/SIL	A2FM32I316L/8-13.5/SIL	
15 - 19,5mm	1.1/2" (38,10mm)	42	61	NITRÍLICA	A2FM32A/13-19.5/NBR	A2FM32L/13-19.5/NBR	A2FM32LN/13-19.5/NBR	A2FM32I304L/13-19.5/NBR	A2FM32I316L/13-19.5/NBR				
					SILICONE	A2FM32A/13-19.5/SIL	A2FM32L/13-19.5/SIL	A2FM32LN/13-19.5/SIL	A2FM32I304L/13-19.5/SIL	A2FM32I316L/13-19.5/SIL			
M40x1,5	15	14 - 20mm	1.3/4" (44,45mm)	50	67	NITRÍLICA	A2FM40A/14-20NBR	A2FM40L/14-20NBR	A2FM40LN/14-20NBR	A2FM40I304L/14-20NBR	A2FM40I316L/14-20NBR		
							SILICONE	A2FM40A/14-20/SIL	A2FM40L/14-20/SIL	A2FM40LN/14-20/SIL	A2FM40I304L/14-20/SIL	A2FM40I316L/14-20/SIL	
		20 - 25,5mm	1.3/4" (44,45mm)	50	67	NITRÍLICA	A2FM40A/20-25.5/NBR	A2FM40L/20-25.5/NBR	A2FM40LN/20-25.5/NBR	A2FM40I304L/20-25.5/NBR	A2FM40I316L/20-25.5/NBR		
							SILICONE	A2FM40A/20-25.5/SIL	A2FM40L/20-25.5/SIL	A2FM40LN/20-25.5/SIL	A2FM40I304L/20-25.5/SIL	A2FM40I316L/20-25.5/SIL	
		14 - 20mm	1.3/4" (44,45mm)	50	67	NITRÍLICA	A2FM40A/14-20NBR	A2FM40L/14-20NBR	A2FM40LN/14-20NBR	A2FM40I304L/14-20NBR	A2FM40I316L/14-20NBR		
							SILICONE	A2FM40A/14-20/SIL	A2FM40L/14-20/SIL	A2FM40LN/14-20/SIL	A2FM40I304L/14-20/SIL	A2FM40I316L/14-20/SIL	
20 - 25,5mm	1.3/4" (44,45mm)	50	67	NITRÍLICA	A2FM40A/20-25.5/NBR	A2FM40L/20-25.5/NBR	A2FM40LN/20-25.5/NBR	A2FM40I304L/20-25.5/NBR	A2FM40I316L/20-25.5/NBR				
					SILICONE	A2FM40A/20-25.5/SIL	A2FM40L/20-25.5/SIL	A2FM40LN/20-25.5/SIL	A2FM40I304L/20-25.5/SIL	A2FM40I316L/20-25.5/SIL			
M50x1,5	15	18 - 23mm	2.1/4" (57,15mm)	62	69	NITRÍLICA	A2FM50A/18-23NBR	A2FM50L/18-23NBR	A2FM50LN/18-23NBR	A2FM50I304L/18-23NBR	A2FM50I316L/18-23NBR		
							SILICONE	A2FM50A/18-23/SIL	A2FM50L/18-23/SIL	A2FM50LN/18-23/SIL	A2FM50I304L/18-23/SIL	A2FM50I316L/18-23/SIL	
		22 - 32mm	2.1/4" (57,15mm)	62	69	NITRÍLICA	A2FM50A/22-32NBR	A2FM50L/22-32NBR	A2FM50LN/22-32NBR	A2FM50I304L/22-32NBR	A2FM50I316L/22-32NBR		
							SILICONE	A2FM50A/22-32/SIL	A2FM50L/22-32/SIL	A2FM50LN/22-32/SIL	A2FM50I304L/22-32/SIL	A2FM50I316L/22-32/SIL	
		18 - 23mm	2.1/4" (57,15mm)	62	69	NITRÍLICA	A2FM50A/18-23NBR	A2FM50L/18-23NBR	A2FM50LN/18-23NBR	A2FM50I304L/18-23NBR	A2FM50I316L/18-23NBR		
							SILICONE	A2FM50A/18-23/SIL	A2FM50L/18-23/SIL	A2FM50LN/18-23/SIL	A2FM50I304L/18-23/SIL	A2FM50I316L/18-23/SIL	
22 - 32mm	2.1/4" (57,15mm)	62	69	NITRÍLICA	A2FM50A/22-32NBR	A2FM50L/22-32NBR	A2FM50LN/22-32NBR	A2FM50I304L/22-32NBR	A2FM50I316L/22-32NBR				
					SILICONE	A2FM50A/22-32/SIL	A2FM50L/22-32/SIL	A2FM50LN/22-32/SIL	A2FM50I304L/22-32/SIL	A2FM50I316L/22-32/SIL			
M63x1,5	20	28 - 36mm	2.3/4" (69,85mm)	75	71	NITRÍLICA	A2FM63A/28-36NBR	A2FM63L/28-36NBR	A2FM63LN/28-36NBR	A2FM63I304L/28-36NBR	A2FM63I316L/28-36NBR		
							SILICONE	A2FM63A/28-36/SIL	A2FM63L/28-36/SIL	A2FM63LN/28-36/SIL	A2FM63I304L/28-36/SIL	A2FM63I316L/28-36/SIL	
		36 - 43mm	2.3/4" (69,85mm)	75	71	NITRÍLICA	A2FM63A/36-43NBR	A2FM63L/36-43NBR	A2FM63LN/36-43NBR	A2FM63I304L/36-43NBR	A2FM63I316L/36-43NBR		
							SILICONE	A2FM63A/36-43/SIL	A2FM63L/36-43/SIL	A2FM63LN/36-43/SIL	A2FM63I304L/36-43/SIL	A2FM63I316L/36-43/SIL	
		28 - 36mm	2.3/4" (69,85mm)	75	77	NITRÍLICA	A2FM63A/28-36NBR	A2FM63L/28-36NBR	A2FM63LN/28-36NBR	A2FM63I304L/28-36NBR	A2FM63I316L/28-36NBR		
							SILICONE	A2FM63A/28-36/SIL	A2FM63L/28-36/SIL	A2FM63LN/28-36/SIL	A2FM63I304L/28-36/SIL	A2FM63I316L/28-36/SIL	
36 - 43mm	2.3/4" (69,85mm)	75	77	NITRÍLICA	A2FM63A/36-43NBR	A2FM63L/36-43NBR	A2FM63LN/36-43NBR	A2FM63I304L/36-43NBR	A2FM63I316L/36-43NBR				
					SILICONE	A2FM63A/36-43/SIL	A2FM63L/36-43/SIL	A2FM63LN/36-43/SIL	A2FM63I304L/36-43/SIL	A2FM63I316L/36-43/SIL			
M75x1,5	20	36,5 - 45mm	3.1/4" (82,55mm)	88	77	NITRÍLICA	A2FM75A/36.5-45NBR	A2FM75L/36.5-45NBR	A2FM75LN/36.5-45NBR	A2FM75I304L/36.5-45NBR	A2FM75I316L/36.5-45NBR		
							SILICONE	A2FM75A/36.5-45/SIL	A2FM75L/36.5-45/SIL	A2FM75LN/36.5-45/SIL	A2FM75I304L/36.5-45/SIL	A2FM75I316L/36.5-45/SIL	
		45 - 55mm	3.1/4" (82,55mm)	88	77	NITRÍLICA	A2FM75A/45-55NBR	A2FM75L/45-55NBR	A2FM75LN/45-55NBR	A2FM75I304L/45-55NBR	A2FM75I316L/45-55NBR		
							SILICONE	A2FM75A/45-55/SIL	A2FM75L/45-55/SIL	A2FM75LN/45-55/SIL	A2FM75I304L/45-55/SIL	A2FM75I316L/45-55/SIL	
		36,5 - 45mm	3.1/4" (82,55mm)	88	77	NITRÍLICA	A2FM75A/36.5-45NBR	A2FM75L/36.5-45NBR	A2FM75LN/36.5-45NBR	A2FM75I304L/36.5-45NBR	A2FM75I316L/36.5-45NBR		
							SILICONE	A2FM75A/36.5-45/SIL	A2FM75L/36.5-45/SIL	A2FM75LN/36.5-45/SIL	A2FM75I304L/36.5-45/SIL	A2FM75I316L/36.5-45/SIL	
45 - 55mm	3.1/4" (82,55mm)	88	77	NITRÍLICA	A2FM75A/45-55NBR	A2FM75L/45-55NBR	A2FM75LN/45-55NBR	A2FM75I304L/45-55NBR	A2FM75I316L/45-55NBR				
					SILICONE	A2FM75A/45-55/SIL	A2FM75L/45-55/SIL	A2FM75LN/45-55/SIL	A2FM75I304L/45-55/SIL	A2FM75I316L/45-55/SIL			

LEGENDA: H - ALTURA APROXIMADA | A - COMPRIMENTO DA ROSCA | Ø EXT - Ø EXTERNO (mm) | ☞ SEXTAVADO

PRENSA CABOS

A2F

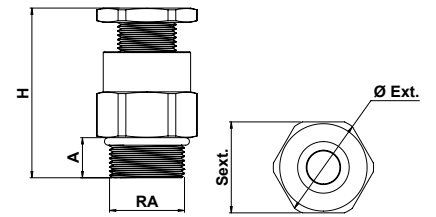

PRENSA CABO A2F | ROSCA MÉTRICA

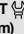
ROSCA (RA)	A	RANGE	SEXT  (mm)	Ø EXT (mm)	H (mm)	VEDAÇÃO	CÓDIGOS				
							ALUMÍNIO	LATÃO	LATÃO NIQUELADO	AÇO INOX 304L	AÇO INOX 316L
M75x1,5	20	41 - 55,5mm	4" (101,60mm)	110	84	NITRÍLICA	A2FM75A/41-55.5NBR	A2FM75L/41-55.5NBR	A2FM75LN/41-55.5NBR	A2FM75I304L/41-55.5NBR	A2FM75I316L/41-55.5NBR
						SILICONE	A2FM75A/41-55.5/SIL	A2FM75L/41-55.5/SIL	A2FM75LN/41-55.5/SIL	A2FM75I304L/41-55.5/SIL	A2FM75I316L/41-55.5/SIL
		54,5 - 67mm	4" (101,60mm)	110	84	NITRÍLICA	A2FM75A/54.5-67NBR	A2FM75L/54.5-67NBR	A2FM75LN/54.5-67NBR	A2FM75I304L/54.5-67NBR	A2FM75I316L/54.5-67NBR
						SILICONE	A2FM75A/54.5-67/SIL	A2FM75L/54.5-67/SIL	A2FM75LN/54.5-67/SIL	A2FM75I304L/54.5-67/SIL	A2FM75I316L/54.5-67/SIL

LEGENDA: H - ALTURA APROXIMADA | A - COMPRIMENTO DA ROSCA | Ø EXT - Ø EXTERNO (mm) |  SEXTAVADO



Santae Equipamentos de Engenharia Ltda.

www.exsuper.com.br



Telefone

+55 (15) 4062-9447

+55 (15) 3285-2029

+55 (15) 99753-0030



e-mail:

exsuper@exsuper.com.br



Endereço

Est. Municipal da Santa Cruz, N°1200

Km 146 | Rod. Marechal Rondon

Bairro Cruz das Almas | Tietê-SP
